

# Day/Night High Res. Color HQ1 Cameras

## JCC-DN4522AFZ

1/4" Day/Night High Res. Color HQ1 Camera



## JCC-DN4535AFZ

1/4" Day/Night High Res. Color HQ1 Camera



JCC-DN4522AFZ

JCC-DN4535AFZ

## Features

- 1/4" Interline Sony HAD CCD
- JCC-DN4522AFZ:22x Zoom  
JCC-DN4535AFZ:35x Zoom
- Color:530 TV Lines B/W:560 TV Lines
- 0.5 Lux@F1.6
- Day & Night (IR-Cut filter Removable, ICR)
- On Screen Display (OSD) set-up menu, Completed Advanced Full Function Built-in
- One PUSH, AT Lock Function, Near Limit
- Support functions: AGC, BLC, FL, AES,
- RS-485 Interface
- DC 12V

## Specification

| Model                 | JCC-DN4522AFZ   | JCC-DN4535AFZ                         |
|-----------------------|---|---------------------------------------|
| Pick Up Element       | 1/4" Interline SONY Super HAD CCD                     |                                       |
| Picture Element       | NTSC: 811(H) x 508(V) ; PAL: 795(H) x 596(V)          |                                       |
| Resolution            | Color: 530 TV Lines BW: 560 TV Lines                  |                                       |
| Lens                  | 22x Zoom ( f=3.9mm~85.8mm, F1.6~F3.7)                 | 35x Zoom ( f=3.6mm~126mm, F1.65~F4.2) |
| Sensitivity           | 0.5 Lux at F1.6                                       |                                       |
| S/N Ratio             | More than 48 dB (AGC Off)                             |                                       |
| Day/Night Function    | IR cut filter with auto switching                     |                                       |
| Zoom Speed            | Max. speed 4 sec./ wide →tele                         | Max. speed 10 sec./ wide →tele        |
| Electronic Shutter    | Auto / Manual   |                                       |
| Shutter Speed         | NTSC: 1/60~1/100,000 sec.<br>PAL: 1/50~1/100,000 sec. |                                       |
| Flickerless Mode      | On / Off  |                                       |
| White Balance         | ATW 2500°K~9600°K                                     |                                       |
| Gain Control          | ON/OFF/SAGC, 0~30dB                                   |                                       |
| Focus                 | Auto / Manual / one push                              |                                       |
| Preset Function       | 64  |                                       |
| OSD                   | For functions setting                                 |                                       |
| External Control      | RS485 with 9600, 4800, 2400 Baud rate                 |                                       |
| Operating Temperature | - 10° ~ +50 °C / RH 85% or Less                       |                                       |
| Video Output          | 1.0 Vp-p Composite Video Output; 75 Ohms              |                                       |
| Power Supply          | DC12V   |                                       |
| Power Consumption     | Max. 4.0W   |                                       |
| Dimensions            | 60(W) x 106(D) x 74(H) mm                             | 62(W) x 112(D) x 74(H) mm             |

## Dimension

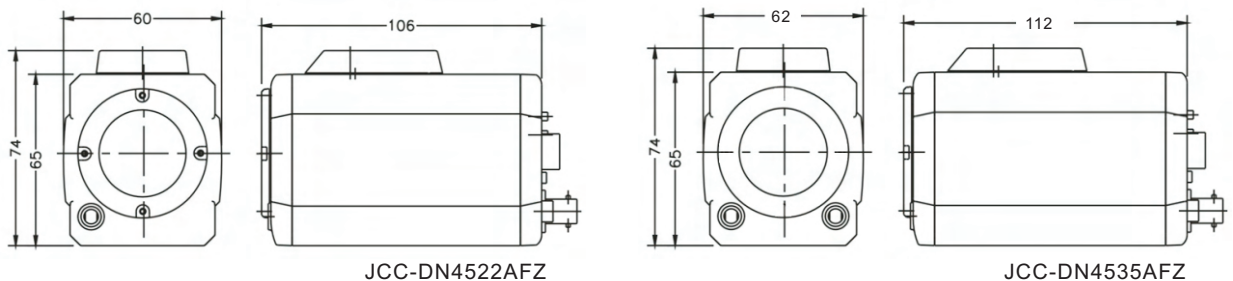

JCC-DN4522AFZ

JCC-DN4535AFZ